

**PITNEY BOWES**  
*Sure-Feed Engineering*

# ***FORCE FLEX***

# ***FEEDER***

***FORCE FLEX-20***

***Parts Manual***

PRELIMINARY



***SURE-FEED ENGINEERING***

12050 49th STREET NORTH - CLEARWATER, FL. 33762-4301  
PHONE: 727.571.3330 - FAX: 727.571.3443 - TOLL FREE: 1.800.INSERTER  
web: [sure-feed.com](http://sure-feed.com)

## FORCE FLEX-20

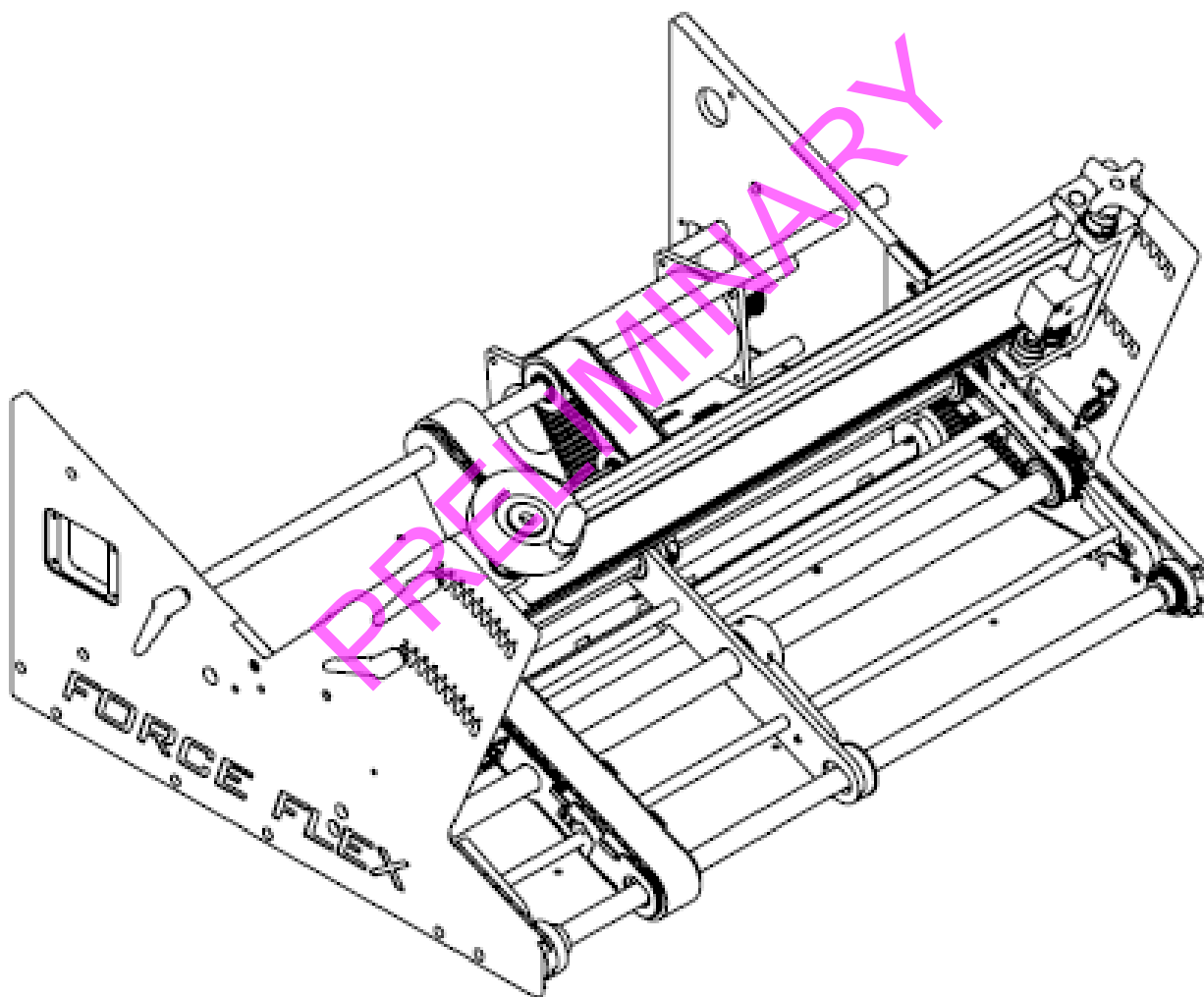

## TABLE OF CONTENTS

20" FORCE FLEX FEEDER ASSEMBLY (FIG. 1).....4  
20" FORCE FLEX FEEDER ASSEMBLY (FIG. 2).....6  
    TRANSPORT BELT CARRIAGE (FIG. 3).....8  
    WIDE BELT TRACK (FIG. 4).....10  
    NARROW BELT TRACK (FIG. 5).....11  
    ELEVATOR ASSEMBLY (FIG. 6).....12  
    CAM AND DRIVE SHAFTS (FIG. 7).....14  
    ADJUSTABLE CROSSBAR (FIG. 8).....16  
    SEPARATOR (FIG. 9).....18  
    BALL RACK FFLEX (FIG 9A).....20  
    SIDE GUIDES (FIG. 10A & B).....21  
    SIDE FRAMES (FIG. 11).....25  
    BOTTOM PLATE & MOTOR (FIG. 12).....27  
    TOP COVER (FIG. 13).....29  
    CARRIAGE TENSIONER & IDLER (FIG. 14).....31

PRELIMINARY

**PITNEY BOWES**  
*Sure-Feed Engineering*

**20" FORCE FLEX FEEDER ASSEMBLY (Fig. 1)  
 (10022-025)**

ITEM	PART NO.	QTY.	DESCRIPTION
1	SEE FIG. 3	1	ASSY, TRANSPORT BELT CARRIAGE (10020-372)
2	SEE FIG. 4	2	ASSY, BELT TRACK, WIDE (10020-337)
3	SEE FIG. 5	2	ASSY, BELT TRACK, NARROW (10020-351)
4	SEE FIG. 6	1	ASSEMBLY, ELEVATOR (10020-373)
5	SEE FIG. 7	1	ASSEMBLY, DRIVE SHAFT (10020-374)
6	SEE FIG. 7	1	ASSEMBLY, CAM SHAFT (10020-375)
7	SEE FIG. 11	1	ASSY, RH SIDEFRAE (10020-406)
8	SEE FIG. 11	1	ASSY, LH SIDEFRAE (10020-407)
9	SEE FIG. 12	1	ASSY, BOTTOM PLATE (10020-493)
10	SEE FIG. 13	1	ASSY, TOP COVER (10020-494)
11	SEE FIG. 12	1	ASSY, MOTOR (10020-426)
12	SEE FIG. 14	1	ASSY, IDLER, CARRIAGE (10020-423)
13	SEE FIG. 14	1	ASSY, TENSIONER, CARRIAGE (10020-424)
14	10012-037	REF	STANDOFF, DC MOTOR SEE FIG 12
15	99000-093	1	BELT, TIMING, 200XL037
16	99000-308	1	BELT, TIMING, DBL SIDE, 230XL075
17	99000-056	1	BELT, TIMNG, 140XL037
18	-	4	SCREW, SKT HEAD, 1/4-20 X 2-1/4
19	-	14	SCREW, SKT HEAD, #10-24 X 1/2
20	-	1	SCREW, SKT HEAD, 5/16-18 X 1/2
21	-	4	SCREW, BUTTON HEAD, #10-24 X 3/8
22	-	1	SCREW, BUTTON HEAD, 1/4-20 X 1/2

# PITNEY BOWES

Sure-Feed Engineering

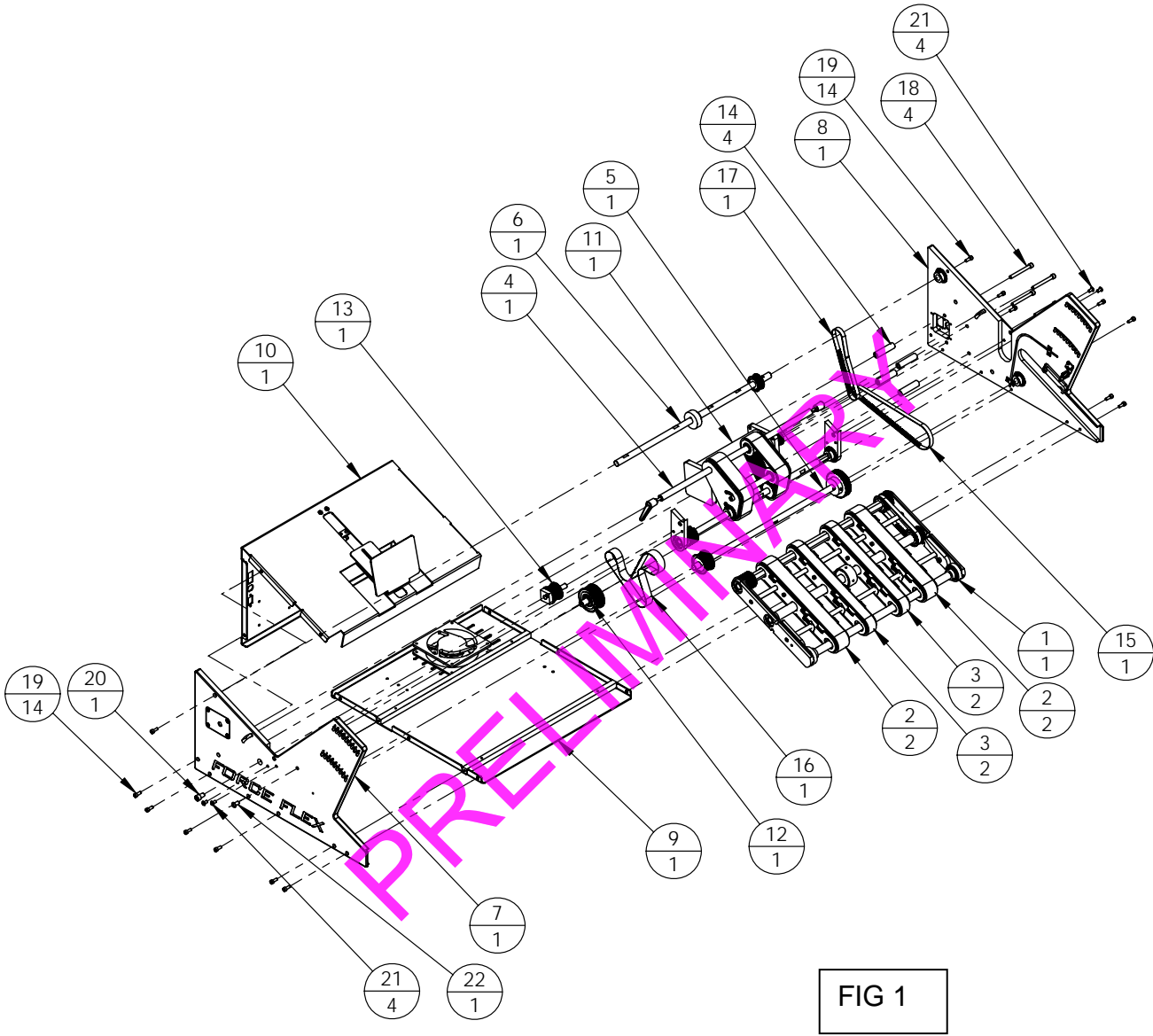

**PITNEY BOWES**  
*Sure-Feed Engineering*

**20" FORCE FLEX FEEDER ASSEMBLY (Fig. 2)**  
**(10022-025)**

ITEM	PART NO.	QTY.	DESCRIPTION
1	SEE FIG. 10	1	ASSY, SIDE GUIDE , LH (10020-342)
2	SEE FIG. 10	1	ASSY, SIDE GUIDE, RH (10020-343)
3	SEE FIG. 8	1	ASSY, ADJUSTABLE CROSSBAR (10020-371)
4	SEE FIG. 9	2	ASST, SEPARATOR (10020-339)
5	OPTIONAL	1	ASSY, SIDE GUIDE, LH NARROW (10020-352)
6	OPTIONAL	1	ASSY, SIDE GUIDE, RH NARROW (10020-353)

PRELIMINARY

**PITNEY BOWES**  
*Sure-Feed Engineering*

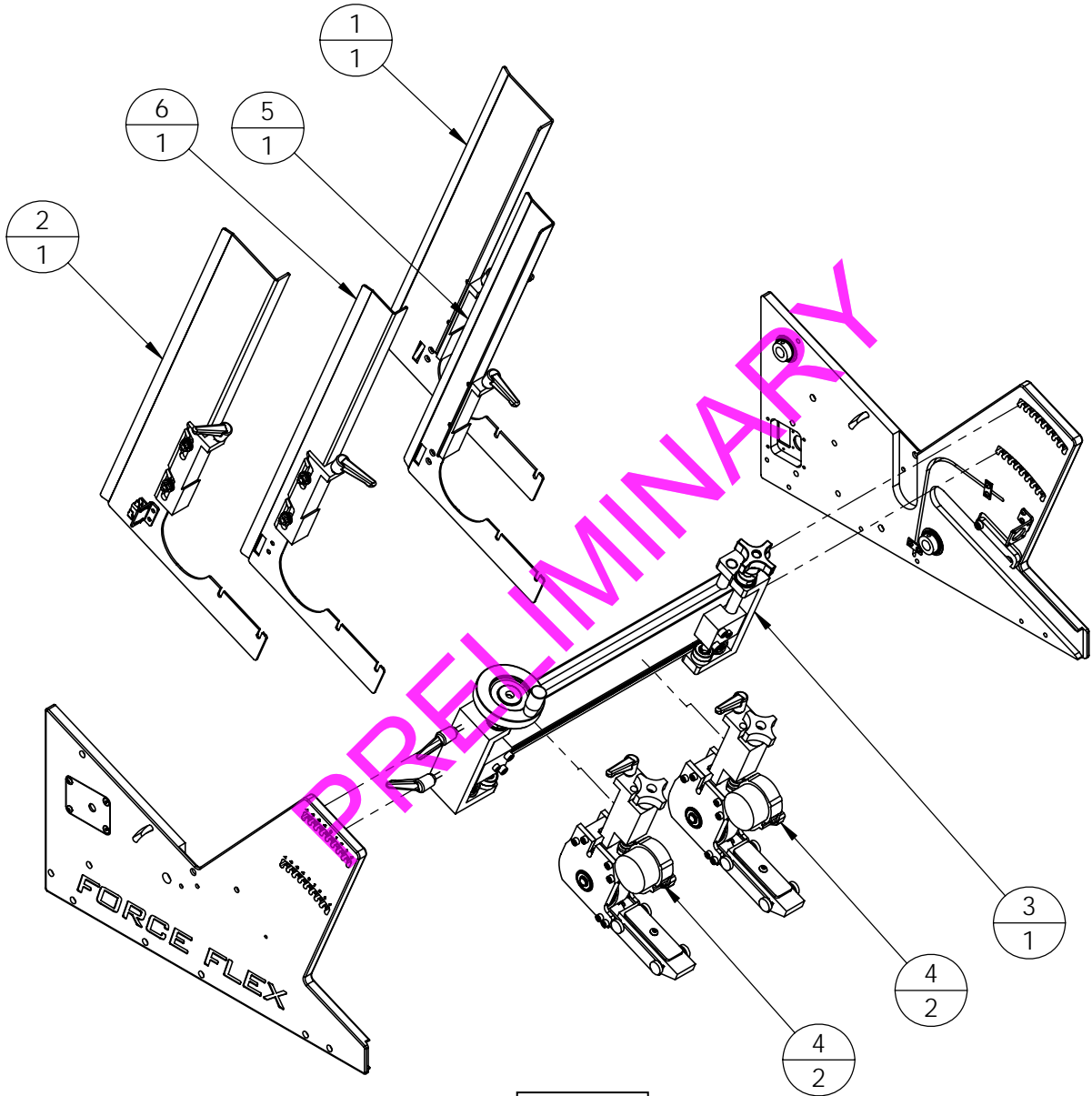

FIG 2

**PITNEY BOWES**  
*Sure-Feed Engineering*

**20" FORCE FLEX FEEDER (Fig. 3)  
 TRANSPORT BELT CARRIAGE ASSEMBLY (10020-372)**

ITEM	PART NO.	QTY.	DESCRIPTION
1	10006-070	1	ROLLER, NIP, 3/4"
2	10004-237	2	SHAFT, BELT TRACK SUPPORT
3	10011-058	2	PLATE, CARRIAGE, SIDE
4	10007-116	2	BLOCK, ADJ BEARING
5	10004-234	1	SHAFT, FRONT IDLER
6	10016-006	3	CAM, BELT TENSIONER
7	99003-093	7	BEARING, 1/2 X 1-1/8, SEALED W/ LOCKING COLLAR
8	10004-258	1	SHAFT, HEX-FEMALE
9	10004-259	1	SHAFT, HEX-MALE
10	10004-236	1	SHAFT, NIP SUPPORT
11	10006-114	1	PULLEY, TIMING, 22XL075 W/ RECESS
12	99002-054	2	PULLEY, TIMING, 20XL037, 1/2 BORE W/ KEYWAY
13	99000-003	1	BELT, TIMING, 120XL027
14	10013-062	1	COVER, PULLEY
15	99034-004	3	KEY, WOODRUFF, 1/2 X 1/8
16	99033-001	2	SHOULDER BOLT, 1/4 X 1
17	99033-004	3	SHOULDER BOLT, 1/4 X 3/8
18	10008-117	1	BAR, CARRIAGE SUPPORT
19	10007-137	1	BLOCK, ADJ BRG-CENTER
20	99003-006	1	BEARING, 5/8 X 1-3/8 W/SNAP RING
21	99017-055	1	COLLAR, 2 PC CLAMP, 5/8
22	-	4	SCREW, SKT HEAD, #10-24 X 1/2
23	-	6	SET SCREW, CUP, #10-24 X 1/4



FIG 3

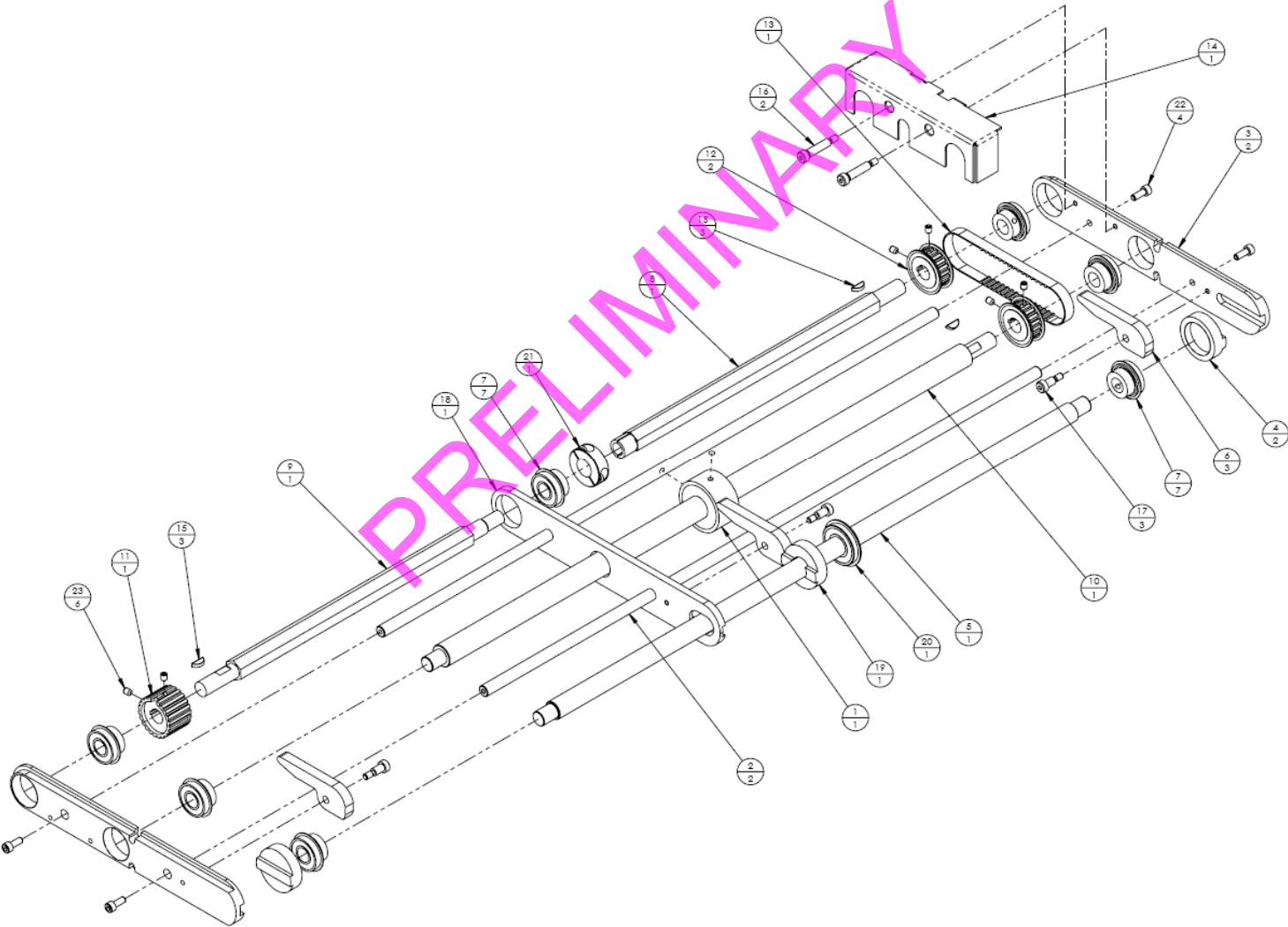

**PITNEY BOWES**  
*Sure-Feed Engineering*

**20" FORCE FLEX FEEDER (Fig. 4)  
 WIDE BELT TRACK ASSEMBLY (10020-337)**

ITEM	PART NO.	QTY.	DESCRIPTION
1	10000-077	1	FRAME, BELT TRACK
2	10011-055	1	PLATE, SPRING, LOCATING
3	10004-202	1	SHAFT, IDLER SUPPORT
4	10006-110	1	PULLEY, BELT TRACK DRIVE
5	10006-111	1	PULLEY, BELT TRACK IDLER
6	10006-113	1	PULLEY, BELT IDLER SUPPORT
7	10006-112	1	PULLEY, BELT TRACK SUPPORT
8	10014-042	1	BELT, FEEDER TRANSPORT, 214XL
9	99003-002	2	BEARING, SEALED, 1/4 X 5/8
10	99003-021	2	WASHER, NYLON, 5/8 X 1/16
11	99003-034	2	WASHER, NYLON, 1/4 X 1/32
12	99003-082	4	WASHER, NYLON, 3/4 X 1/16
13	-	2	SCREW, SKT HEAD, #8-32 X 1/2
14	-	1	#6 SHEET METAL SCREW, SELF TAPPING

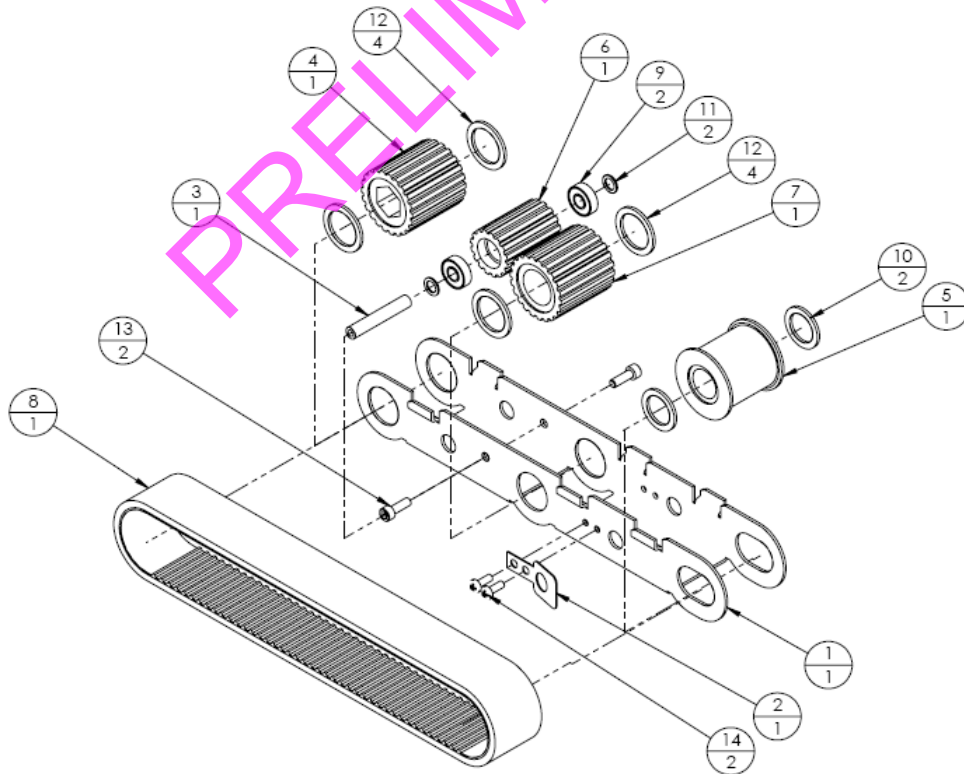

**20" FORCE FLEX FEEDER (Fig. 5)  
 NARROW BELT TRACK ASSEMBLY (10020-351)**

ITEM	PART NO.	QTY.	DESCRIPTION
1	10000-080	1	FRAME, BELT TRACK, NARROW
2	10006-119	1	PULLEY, BELT TRACK DRIVE, NARROW
3	10006-120	1	PULLEY, BELT TRACK IDLER, NARROW
4	10006-122	1	PULLEY, BELT IDLER SUPPORT, NARROW
5	10006-121	1	PULLEY, BELT TRACK SUPPORT, NARROW
6	99003-021	2	WASHER, NYLON, 5/8 X 1/16
7	99003-034	2	WASHER, NYLON, 1/4 X 1/32
8	99003-082	4	WASHER, NYLON, 3/4 X 1/16
9	10014-044	1	BELT, FEEDER TRANSPORT, 214XL, 7/8 WIDE
10	10004-232	1	SHAFT, IDLER SUPPORT, NARROW
11	10011-055	1	PLATE, SPRING LOCATING
12	99003-002	2	BEARING, SEALED, 1/4 X 5/8
13	-	2	SCREW, SKT HEAD, #8-32 X 1/2
14	-	1	SCREW, PAN HD, #6-32 X 3/8

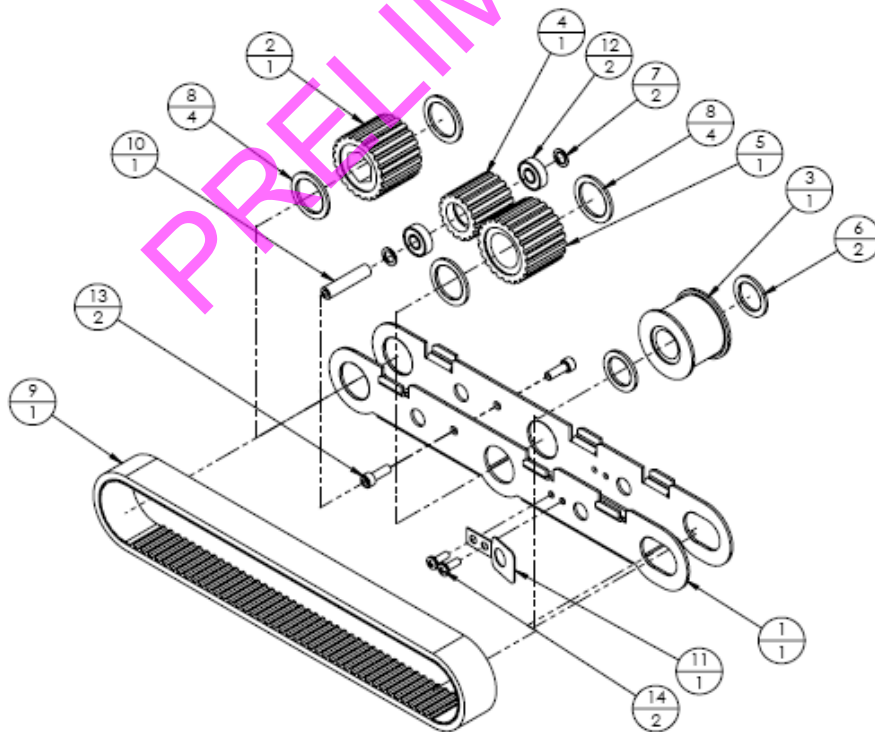

**PITNEY BOWES**  
*Sure-Feed Engineering*

**20" FORCE FLEX FEEDER (Fig. 6)  
 ELEVATOR ASSEMBLY (10020-373)**

ITEM	PART NO.	QTY.	DESCRIPTION
1	10011-061	2	PLATE, ELEVATOR SIDE
2	10004-229	1	SHAFT, ELEVATOR IDLER
3	10014-043	2	BELT, ELEVATOR, 130XL, 1.25" WIDE
4	10006-116	2	PULLEY, TIMING, 22XL125, 1/2" BORE
5	10006-115	4	PULLEY, ELEVATOR IDLER
6	10006-114	1	PULLEY, DRIVE, 22XL075 W/ RECESS
7	99003-093	4	BEARING, 1/2 X 1-1/8, SEALED W/ LOCKING COLLAR
8	99003-046	8	BEARING, 1/2 X 7/8
9	99003-018	8	WASHER, NYLON, 1/2 X 1/16
10	99003-032	2	WASHER, NYLON, 1/2 X 1/32
11	99022-004	4	SNAP RING, 1/2"
12	99004-027	2	HANDLE, ADJ, #10-24 X 1.18
13	10007-121	2	BLOCK, ELEVATOR BEARING
14	10004-239	1	SHAFT, ELEVATOR ADJ.
15	10013-053	1	GUARD, ELEV BELT-RH
16	10013-054	1	GUARD, ELEV BELT-LH
17	99003-013	2	WASHER, NYLON, 1/4 X 1/16
18	10004-238	1	SHAFT, FEEDER DRIVE

PRELIMINARY

**PITNEY BOWES**  
*Sure-Feed Engineering*

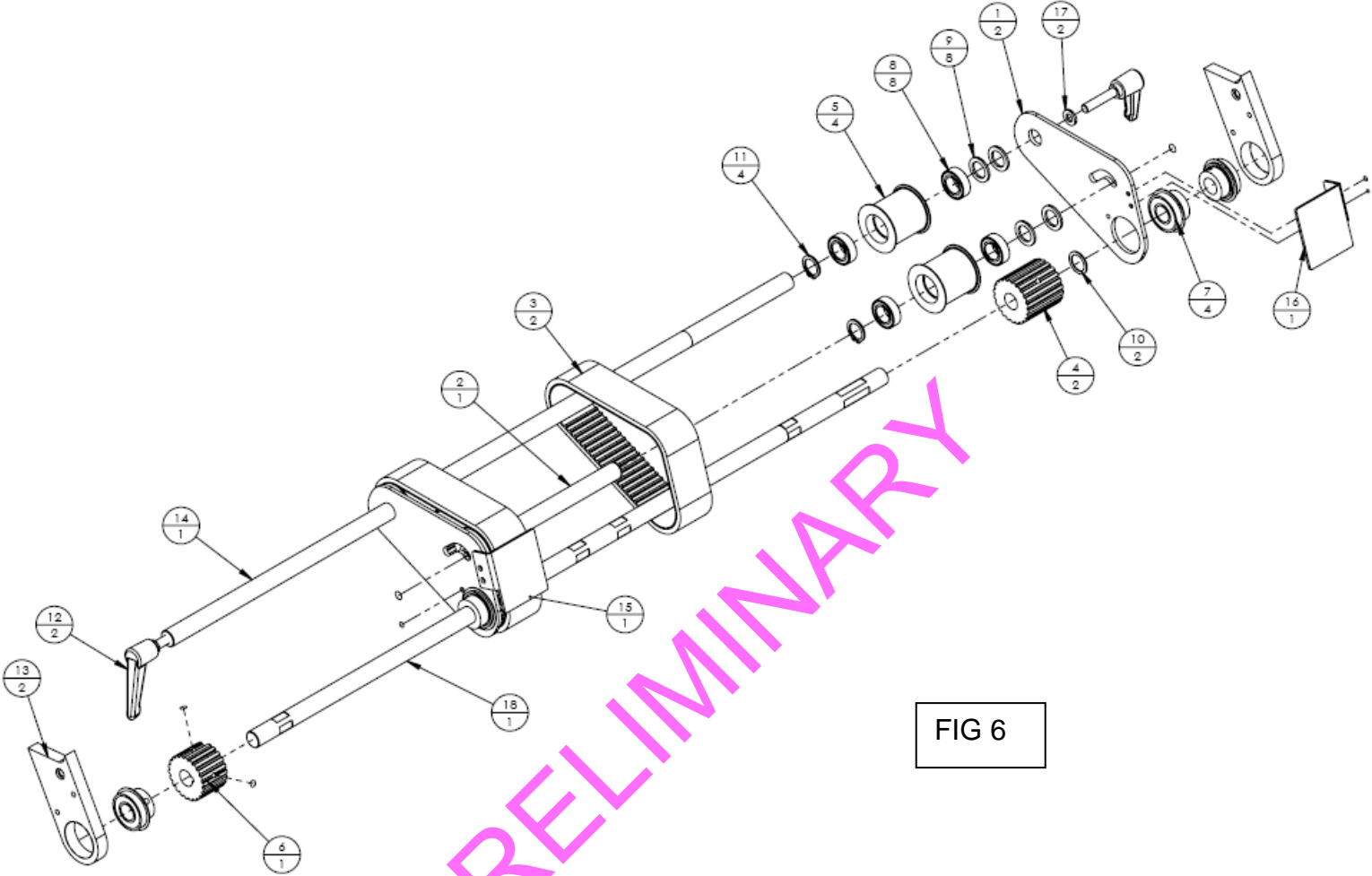

FIG 6

PRELIMINARY

**20" FORCE FLEX FEEDER (Fig. 7)  
 CAM AND DRIVE SHAFT ASSEMBLIES**

ITEM	PART NO.	QTY.	DESCRIPTION
	<b>10020-375</b>	<b>1</b>	<b>ASSEMBLY, CAM SHAFT</b>
8	10004-238	1	SHAFT, FEEDER DRIVE
9	10006-048	1	CAM, VIBRATING TOP PLATE
10	99002-026	1	PULLEY, TIMING, 18XL037, 1/2 BORE
	-	3	SET SCREW, CUP, #8-32 X 1/4
	-	1	SET SCREW, CUP, #8-32 X 3/16
13	99034-003	1	KEY, SQUARE, 1/8 X 3/4
	<b>10020-374</b>	<b>1</b>	<b>ASSEMBLY, DRIVE SHAFT</b>
2	10004-238	1	SHAFT, FEEDER DRIVE
3	99002-005	1	PULLEY, TIMING, 36XL037, 1/2 BORE
4	99002-131	1	PULLEY, TIMING, 24XL075, 1/2 BORE W/ 1/8 K'WAY
5	99034-004	1	KEY, WOODRUFF, 1/2 X 1/8
	-	2	SET SCREW, CUP, #10-24 X 1/2
	-	2	SET SCREW, CUP, #10-24 X 1/4

PRELIMINARY

**PITNEY BOWES**  
*Sure-Feed Engineering*

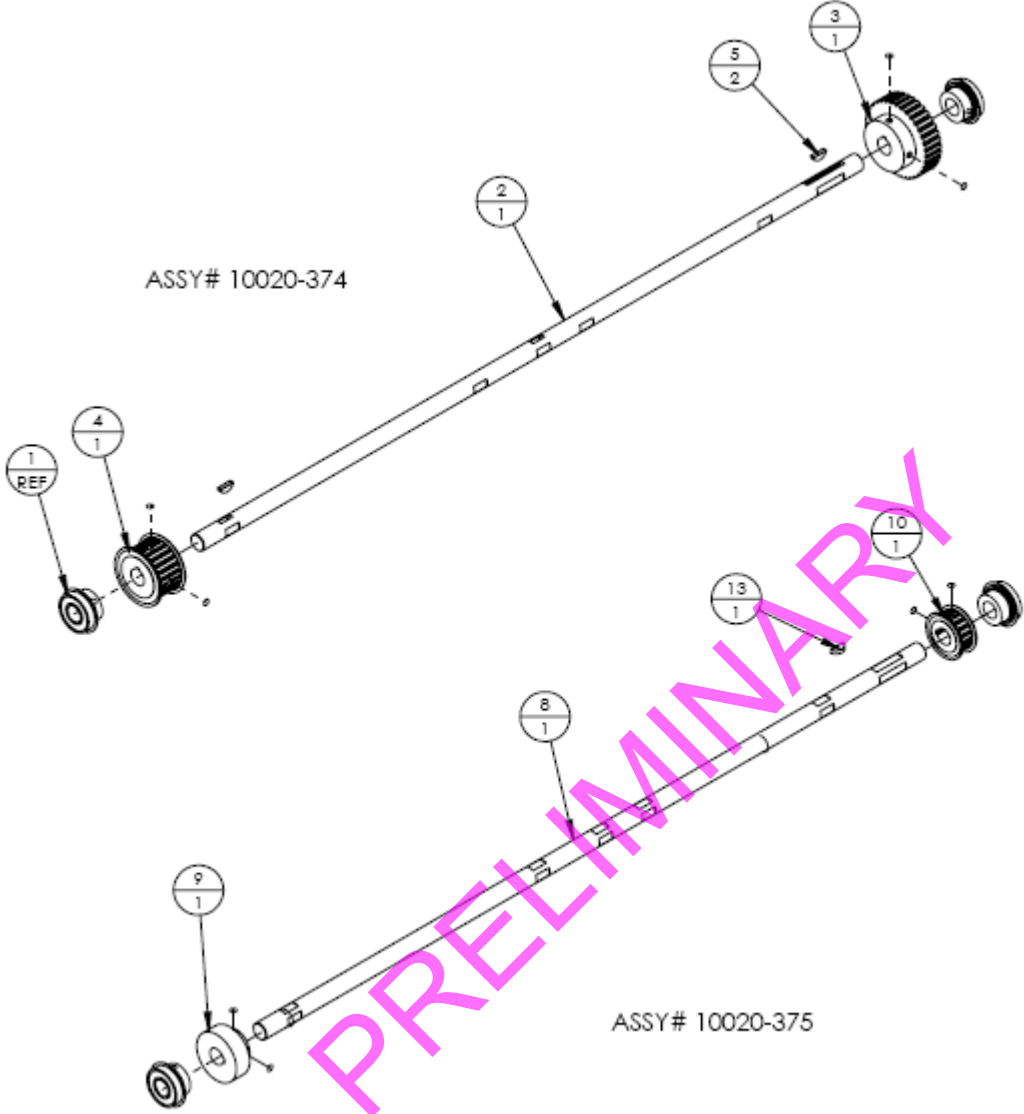

FIG 7

**PITNEY BOWES**  
*Sure-Feed Engineering*

**20" FORCE FLEX FEEDER (Fig. 8)  
 ADJUSTABLE CROSSBAR ASSEMBLY (10020-371)**

ITEM	PART NO.	QTY.	DESCRIPTION
1	10009-076	1	BRACKET, ADJ CROSSBAR, RH
2	10003-027	1	CROSSBAR, ADJUSTABLE
3	10004-227	2	SHAFT, ADJ CROSSBAR GUIDE
4	10004-225	2	SHAFT, THREADED, CROSSBAR ADJUSTING
5	10007-118	2	BLOCK, ADJUSTMENT NUT RETAINER
6	10019-013	1	KNOB, 2" O.D, 3/8 B ALUM
7	10009-077	1	BRACKET, ADJ. CROSSBAR, LH
8	10019-012	2	NUT, CROSSBAR ADJUSTMENT
9	99003-020	4	BEARING, 3/8 X 7/8 SEALED W/ S.R.
10	10004-226	2	SHAFT, STUB, ECCENTRIC IDLER
11	99002-142	2	PULLEY, TIMING, 32MXL025, 3/8 BORE
12	99003-001	4	BEARING, 3/8 X 7/8, SHIELDED
13	99022-003	2	GRIP RING, 3/8"
14	99022-009	2	SNAP RING, 3/8 EXTERNAL
15	99004-033	4	HANDLE, RACHET, #10-24 X .98
16	99003-016	2	WASHER, NYLON, 3/8 X 1/32
17	99017-048	2	COLLAR, ONE PIECE CLAMP, 3/8 BORE
18	10019-014	1	HANDWHEEL, 3/8 BORE W/ HANDLE
19	99000-319	1	BELT, TIMING, 600MXL025 (48" x 600 T X .080 PITCH)
	-	4	SCREW, SKT HEAD, 1/4-20 X 1-3/8
	-	4	SET SCREW, CUP, 1/4-28 X 1/4
	-	4	SET SCREW, CUP, #8-32 X 1/8
	-	2	SET SCREW, CUP, #10-24 X 3/8
	-	2	SCREW, SKT HEAD, #10-24 X 7/8
	-	2	SCREW, SKT HEAD, #10-24 X 3/4



**PITNEY BOWES**  
*Sure-Feed Engineering*

FIG 8

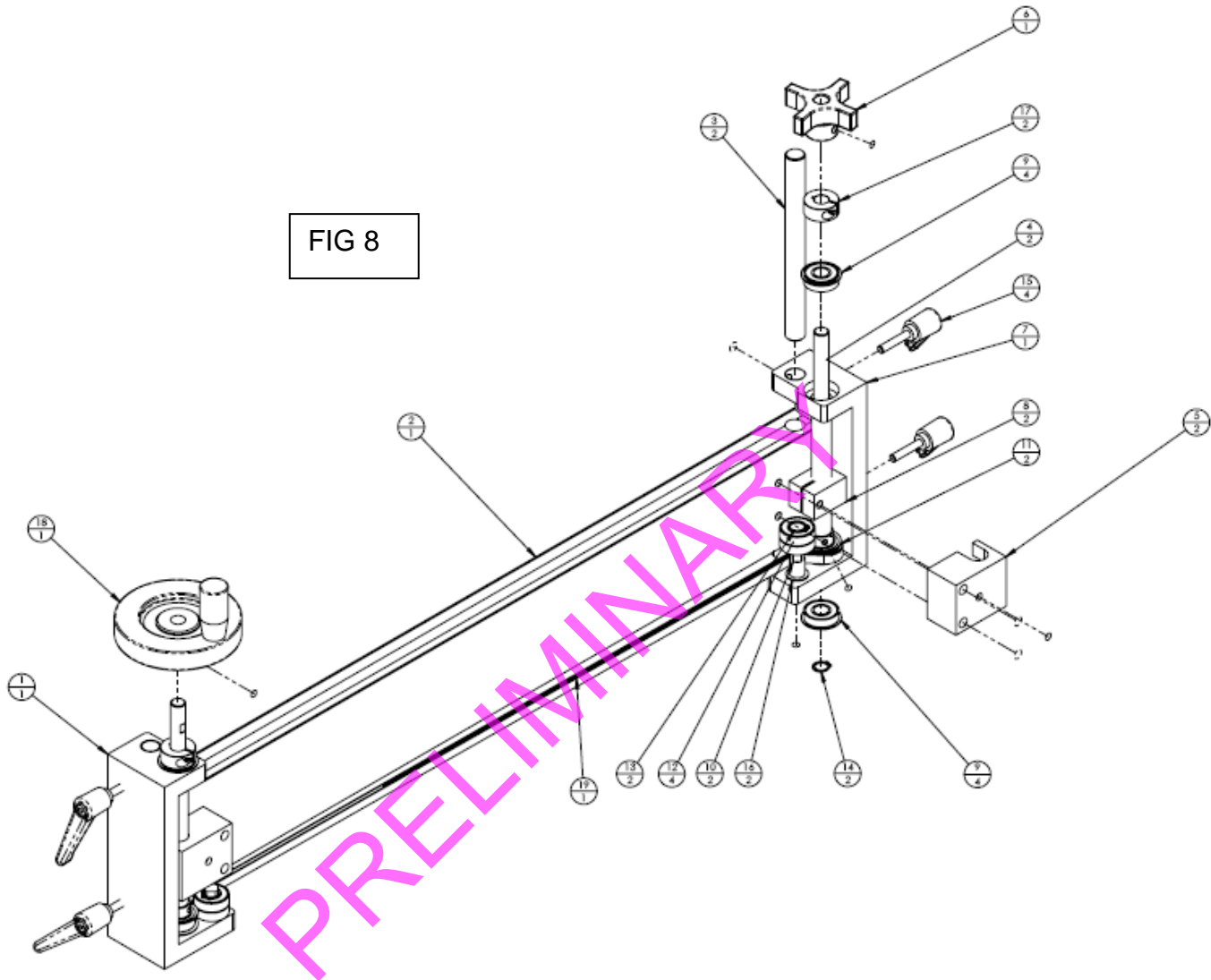

**PITNEY BOWES**  
*Sure-Feed Engineering*

**20" FORCE FLEX FEEDER (Fig. 9)  
 SEPARATOR ASSEMBLY (10020-339)**

ITEM	PART NO.	QTY.	DESCRIPTION
1	10006-001	1	WHEEL, SEPARATOR, 3"
2	10014-001	1	BELT, SEPARATOR
3	10004-224	1	SHAFT, SEPARATOR
4	10007-117	1	BLOCK, SEPARATOR MTG.
5	10007-125	1	BLOCK, SEPARATOR MTG, REAR
6	10011-060	1	PLATE, SEPARATOR, LH SIDE
7	10011-059	1	PLATE, SEPARATOR, RH SIDE
8	10018-074	1	ASSEMBLY, MOTOR SEPARATOR W/ PLUG (24 VAC)
-	99002-002	1	PULLEY, TIMING, 16MXL025, 3/16 BORE
10	99002-001	1	PULLEY, TIMING, 100MXL025, 3/8 BORE
11	99000-311	1	BELT, TIMNG, 134MXL025
12	99006-002	2	PIN, DOWEL, 5/16 X 3
13	10004-211	1	STUD, SEPARATOR ADJUSTMENT
14	99003-020	2	BEARING, 3/8 X 7/8, SEALED W/ S.R.
15	99022-009	1	SNAP RING, 3/8 EXTERNAL
16	99003-016	1	WASHER, NYLON, 3/8 X 1/32
17	10007-123	1	BLOCK, SEPARATOR ADJ.
18	99005-045	1	SPRING, SEPARATOR
19	99004-003	1	HANDLE, RATCHET, #10-24 X 5/8
20	99004-001	1	KNOB, 5/16-24 FEMALE
21	99003-015	1	WASHER, NYLON, 5/16 X 1/16
<b>22</b>	<b>SEE FIG 9A</b>	<b>1</b>	<b>ASSY, BALL RACK-FF (10020-405)</b>

**PITNEY BOWES**  
*Sure-Feed Engineering*

FIG 9

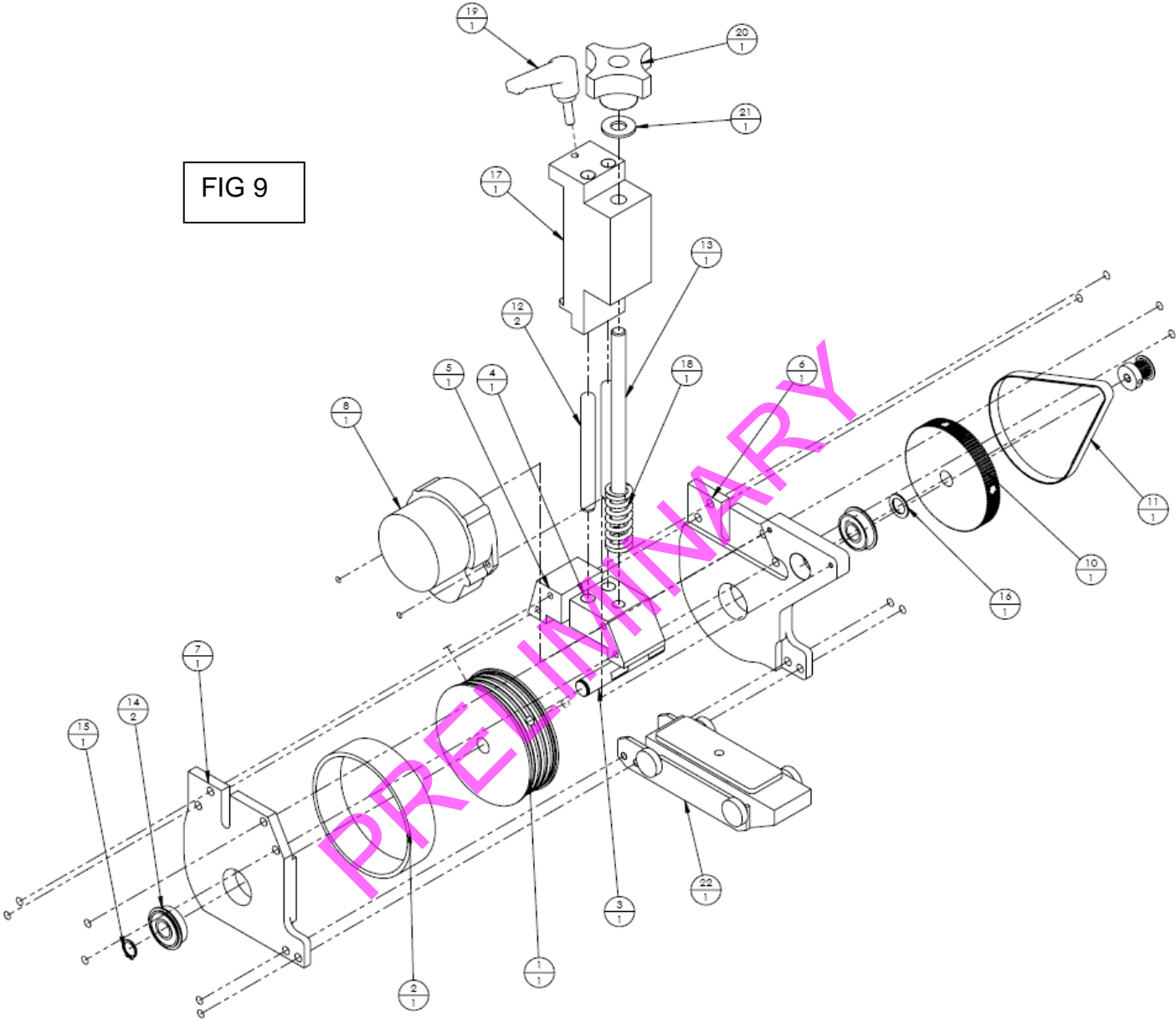

**PITNEY BOWES**  
*Sure-Feed Engineering*

**20" FORCE FLEX FEEDER ASSEMBLY (Fig. 9A)**  
**BALL RACK FFLEX (10020-405)**

ITEM	PART NO.	QTY.	DESCRIPTION
1	10007-119	1	BLOCK, BALL RACK
2	10008-106	2	BAR, BALL RACK MTG.
3	99037-005	2	BALL, 1" ACRYLIC
4	10013-041	1	COVER, BALL RACK
5	10020-316	4	ASSY, KNOB

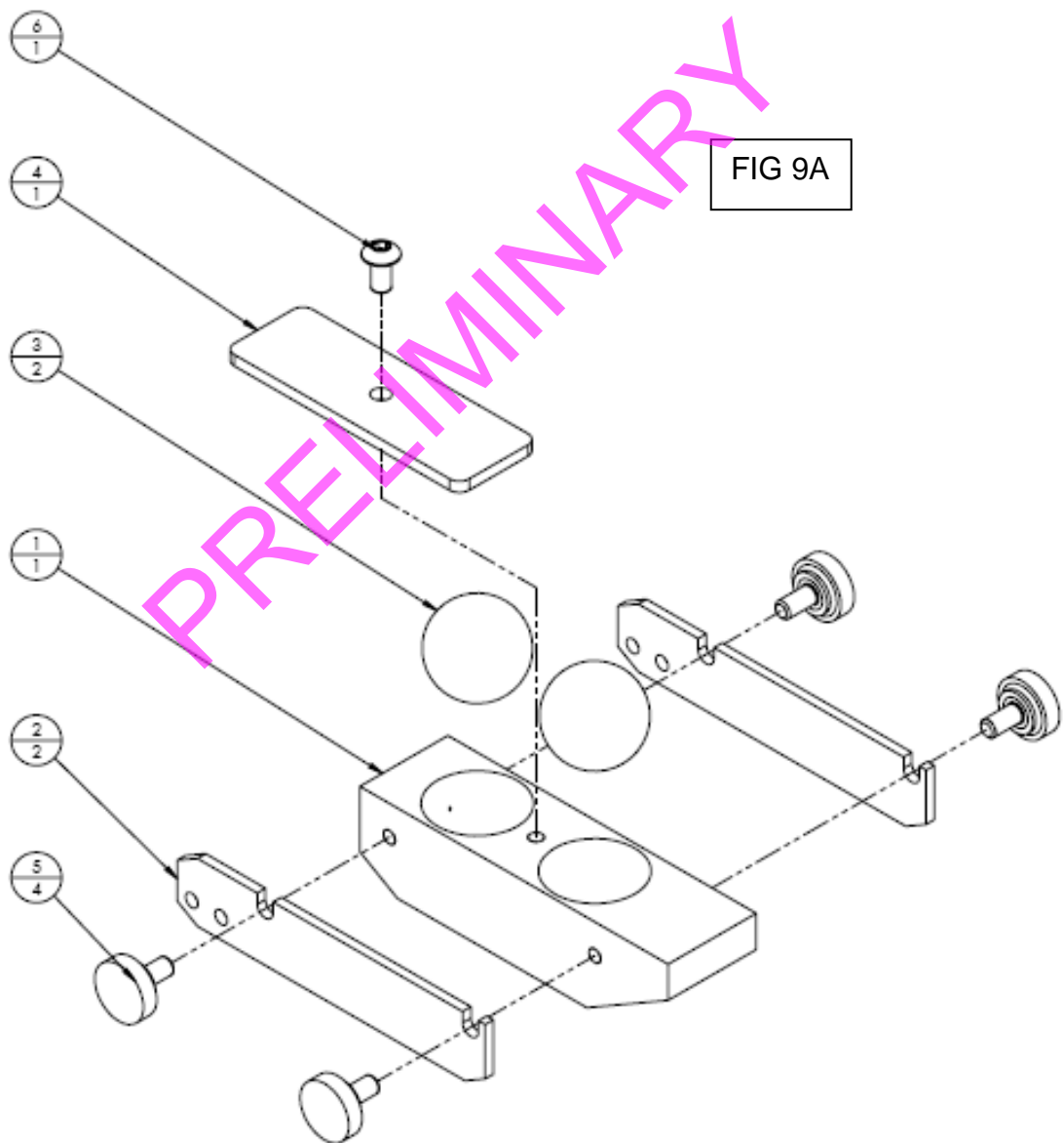

**20" FORCE FLEX FEEDER (Fig. 10A)  
 SIDE GUIDE ASSEMBLIES**

ITEM	PART NO.	QTY.	DESCRIPTION
	<b>10020-342rA</b>	<b>1</b>	<b>ASSEMBLY, SIDE GUIDE, LH</b>
1	10009-079	1	BRACKET, SIDE GUIDE MTG, LH
2	10005-179	1	SIDE GUIDE, LH
3	10005-204	1	GUIDE, PRODUCT SWITCH COVER
4	10012-039	2	SPACER, SIDE GUIDE MTG.
5	99003-012	2	WASHER, NYLON, .203 X .562 X .040
6	99005-058	8	SPRING WASHER, .190 X .562 X .019
7	99004-003	1	HANDLE, RATCHET, #10-24 X 5/8
8	99039-187	2	CAP, VINYL, 1/2 X 3/4
<b>9</b>	<b>10018-144</b>	<b>1</b>	<b>ASSY, LOW PRODUCT SWITCH-FFLEX LH</b>
-1	10009-107	1	BRACKET, SWITCH MTG.
-2	10013-063	1	COVER, LOW PRODUCT SWITCH, RH
-3	10019-016	1	SWITCH, CHERRY
-4	98016-239	1	CONNECTOR, LIMIT SWITCH, 3 POS
-6	98010-189	1	CABLE, COILED, 22/3
-7	98015-048	1	GROMMET, 3/16
-8	98016-211	1	BACKSHELL, 90 °
-9	98016-153	1	PLUG, 8 PIN, MALE
-10	98016-146	2	PIN, GOLD 20-24 AWG
-11	-	2	BHCS, #6-32 X 1/2
-12	-	2	BHCS, #6-32 X 1/4
10	-	4	SCREW, FLAT HD, #6-32 X 3/8
11	-	2	NUT, NYLOCK, #10-32
12	-	2	NUT, NYLOCK, #6-32

# PITNEY BOWES

Sure-Feed Engineering

## ASSEMBLY, SIDE GUIDE, LH

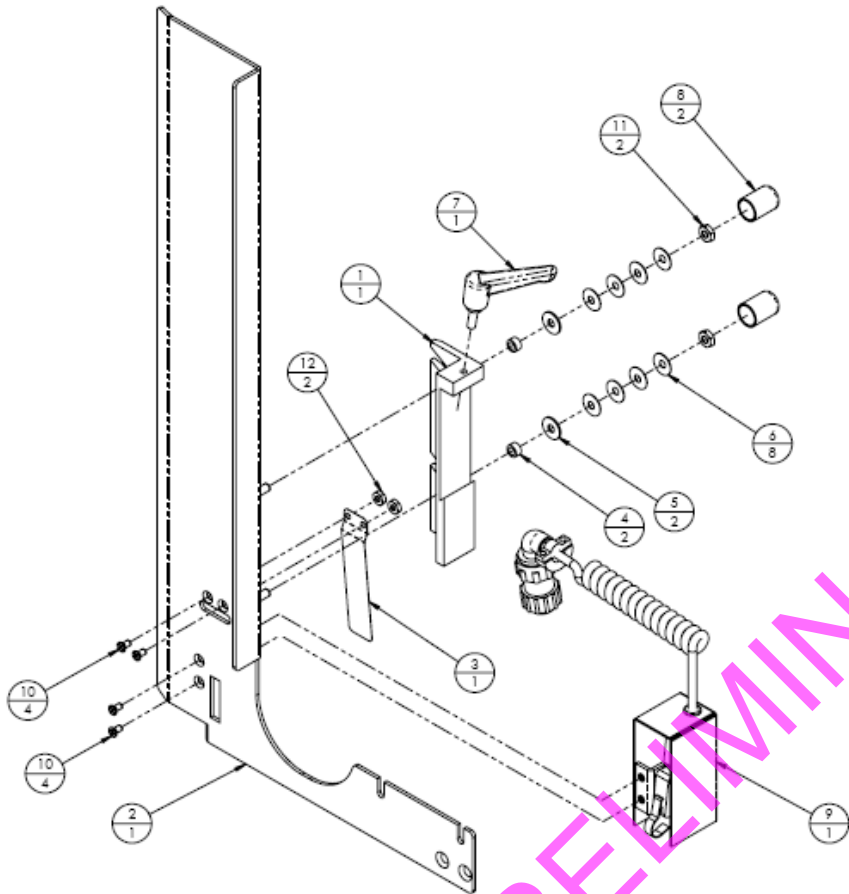
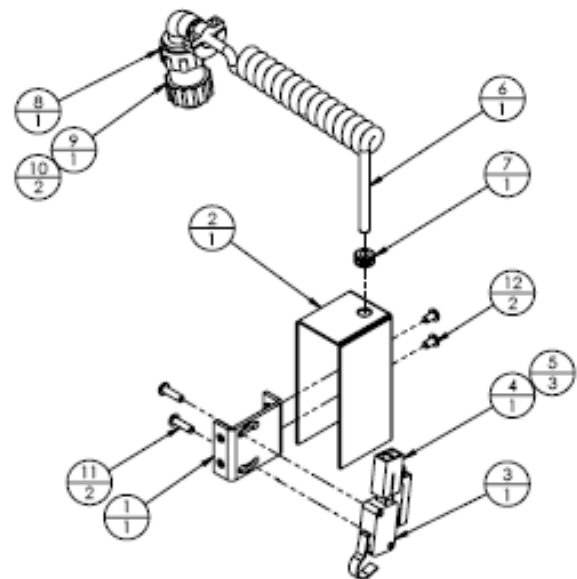

FIG 10A

PRELIMINARY



ASSY, LOW PRODUCT SWITCH

**20" FORCE FLEX FEEDER (Fig. 10B)  
 SIDE GUIDE ASSEMBLIES**

ITEM	PART NO.	QTY.	DESCRIPTION
	<b>10020-343rA</b>	<b>1</b>	<b>ASSEMBLY, SIDE GUIDE, RH</b>
1	10009-078	1	BRACKET, SIDE GUIDE MTG, RH
2	10005-178	1	SIDE GUIDE, RH
3	10005-204	1	GUIDE, PRODUCT SWITCH COVER
4	10012-039	2	SPACER, SIDE GUIDE MTG.
5	99003-012	2	WASHER, NYLON, .203 X .562 X .040
6	99005-058	8	SPRING WASHER, .190 X .562 X .019
7	99004-003	1	HANDLE, RATCHET, #10-24 X 5/8
8	99039-187	2	CAP, VINYL, 1/2 X 3/4
<b>9</b>	<b>10018-122</b>	<b>1</b>	<b>ASSY, LOW PRODUCT SWITCH-FFLEX RH</b>
-1	10009-107	1	BRACKET, SWITCH MTG.
-2	10013-064	1	COVER, LOW PRODUCT SWITCH, LH
-3	10019-016	1	SWITCH, CHERRY
-4	98016-239	1	CONNECTOR, LIMIT SWITCH, 3 POS
-6	98010-189	1	CABLE, COILED, 22/3
-7	98015-048	1	GROMMET, 3/16
-8	98016-211	1	BACKSHELL, 90 °
-9	98016-153	1	PLUG, 8 PIN, MALE
-10	98016-146	2	PIN, GOLD 20-24 AWG
-11	-	2	BHCS, #6-32 X 1/2
-12	-	2	BHCS, #6-32 X 1/4
10	-	4	SCREW, FLAT HD, #6-32 X 5/16
11	-	2	NUT, NYLOCK, #10-32
12	-	2	NUT, NYLOCK, #6-32

# PITNEY BOWES

*Sure-Feed Engineering*

## ASSEMBLY, SIDE GUIDE, RH

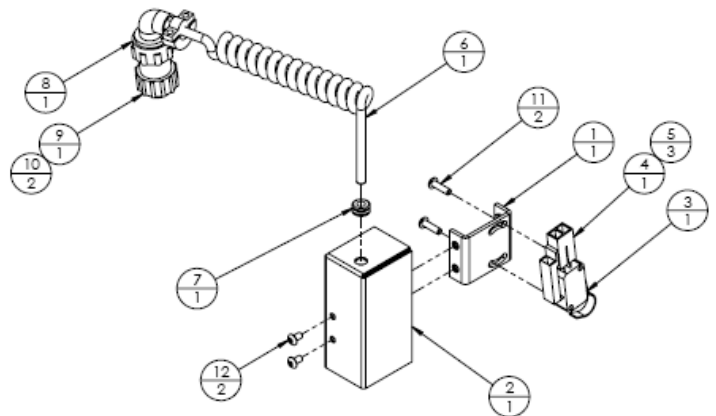
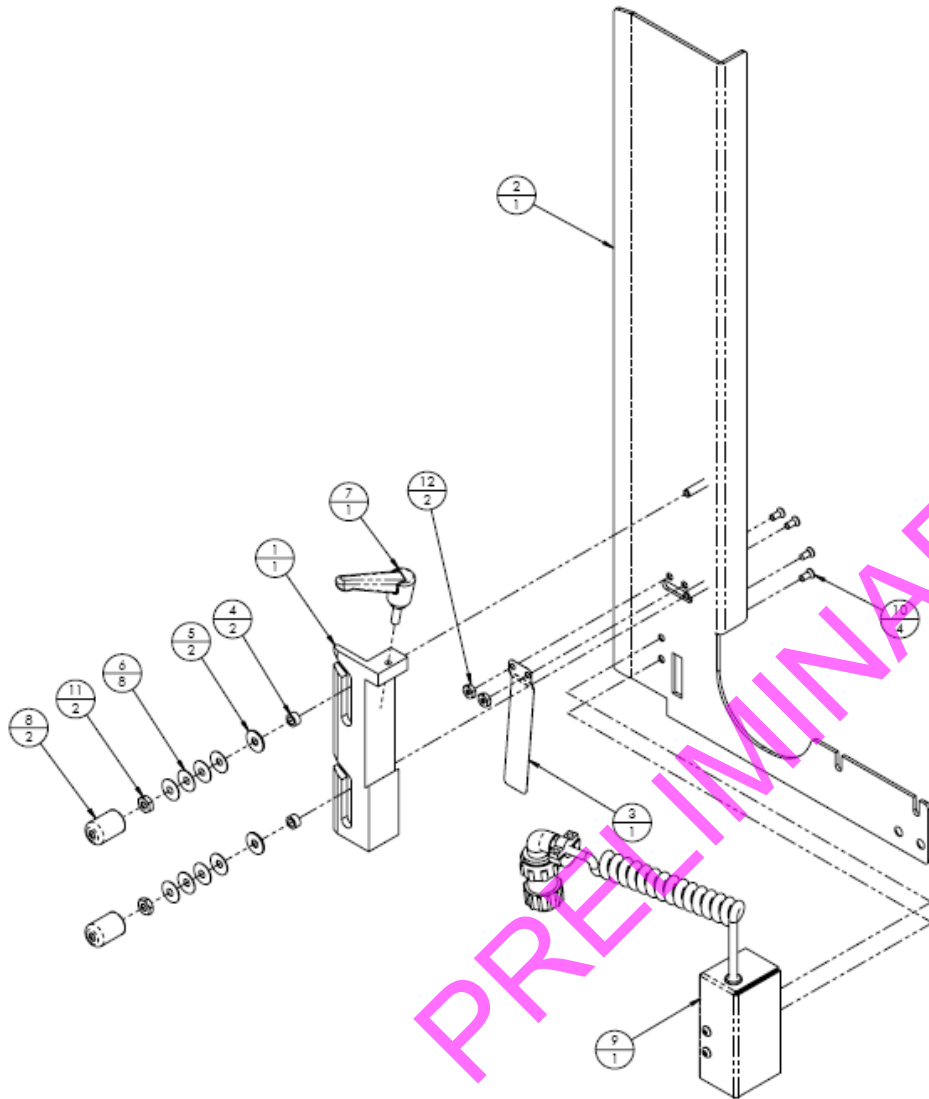

## ASSY, LOW PRODUCT SWITCH



**20" FORCE FLEX FEEDER (Fig. 11)  
 SIDE FRAME ASSEMBLIES**

ITEM	PART NO.	QTY.	DESCRIPTION
	<b>10020-406</b>	<b>1</b>	<b>ASSEMBLY, RH SIDEFAME</b>
1	10000-078	1	SIDEFAME, RH
2	99003-093	2	BEARING, 1/2 X 1-1/8, SEALED W/ LOCKING COLLAR
3	99036-003	2	SHIM, BEARING, 3/4 X 1-1/8 X .009
4	10008-107	1	LATCH, CARRIAGE
5	99033-006	1	SHOULDER BOLT, 1/4 X 1/4
6	10011-068	1	PLATE, WIRE CLAMP
7	10009-095	1	BRACKET, DBL PLUG MTG, RH
8	10011-065	1	BRACKET, SPEED POT MTG
9	-	2	SCREW, BUTTON HEAD, #8-32 X 3/8
10	-	2	SCREW, FLAT HEAD, #8-32 X 3/8
11	-	4	SCREW, BUTTON HEAD, #6-32 X 3/8
	<b>10020-407</b>	<b>1</b>	<b>ASSEMBLY, LH SIDEFAME</b>
12	10000-079	1	SIDEFAME, LH
13	10011-063	1	PLATE, ELECTRICAL CONNECTOR, LH
14	99003-093	2	BEARING, 1/2 X 1-1/8, SEALED W/ LOCKING COLLAR
15	99036-003	2	SHIM, BEARING, 3/4 X 1-1/8 X .009
16	10008-107	1	LATCH, CARRIAGE
17	10011-068	2	PLATE, WIRE CLAMP
18	10009-096	1	BRACKET, DBL PLUG MTG, LH
19	99033-006	1	SHOULDER BOLT, 1/4 X 1/4
20	-	6	SCREW, BUTTON HEAD, #6-32 X 3/8
21	-	4	SCREW, BUTTON HEAD, #8-32 X 3/8

**PITNEY BOWES**  
*Sure-Feed Engineering*

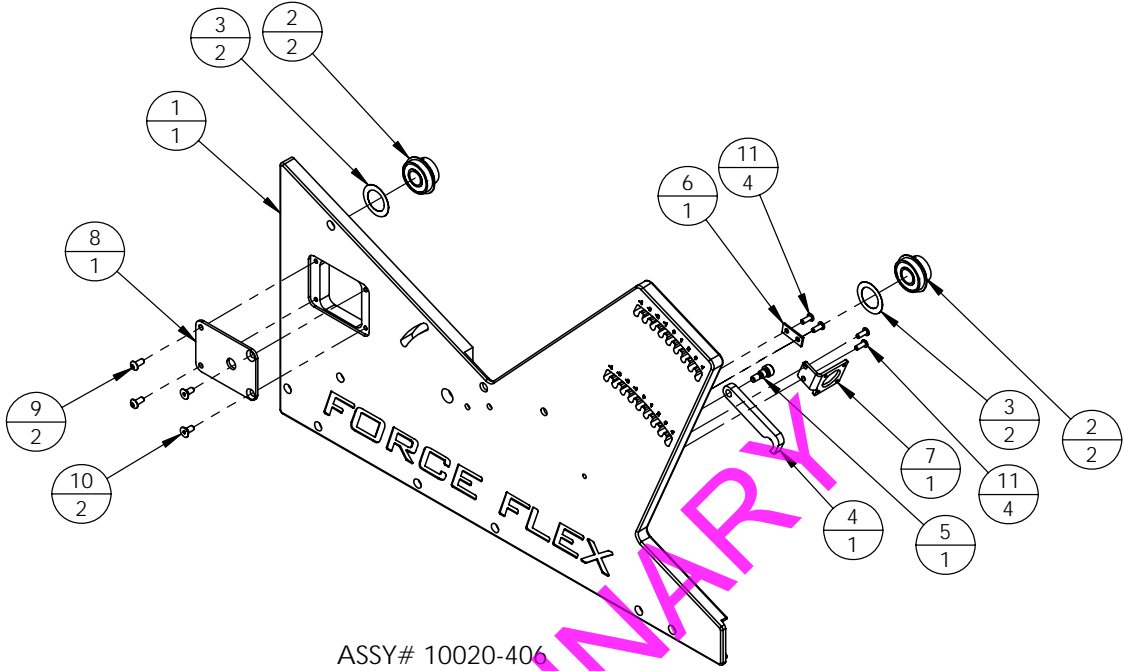

ASSY# 10020-406

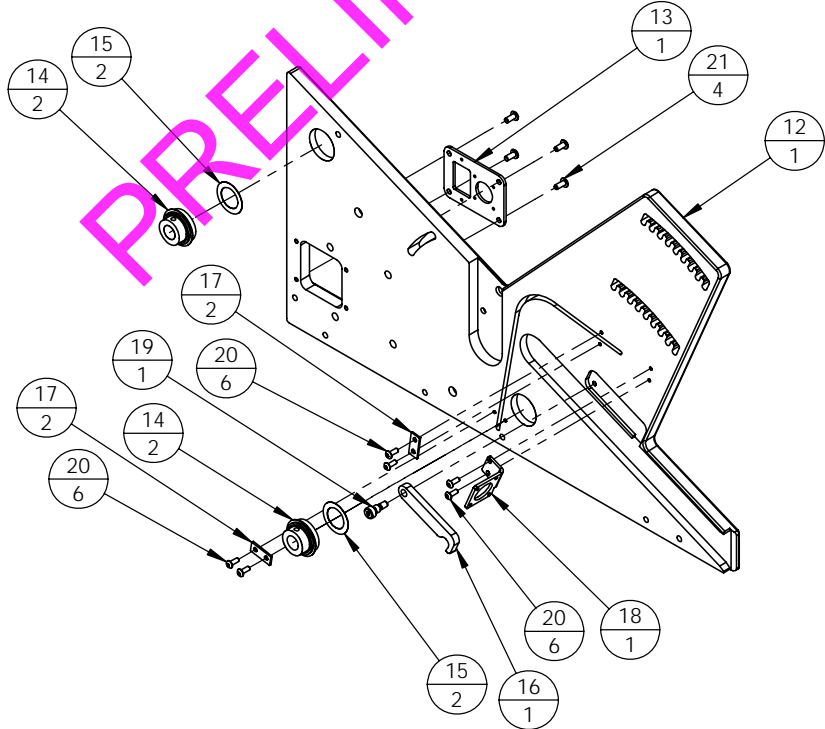

ASSY# 10020-407

**20" FORCE FLEX FEEDER CHASSIS 10020-492 (Fig. 12)  
 BOTTOM PLATE & MOTOR DRIVE ASSEMBLIES**

ITEM	PART NO.	QTY.	DESCRIPTION
	<b>10020-426</b>	<b>1</b>	<b>ASSEMBLY, MOTOR DRIVE</b>
1	99001-050	1	MOTOR, 1/4 HP, 90VDC, 3500 RPM
2	99002-048	1	PULLEY, TIMING, 16XL037, 1/2" BORE
3	99002-067	1	PULLEY, TIMING, 15XL037, 1/2" BORE
4	10012-037	4	STANDOFF, DC MOTOR
5	-	2	SET SCREW, #8-32 X 3/16 FLAT
	-	2	SET SCREW, #8-32 X 1/8 FLAT
	<b>10020-493</b>	<b>1</b>	<b>ASSEMBLY, BOTTOM PLATE</b>
6	10002-025	1	BOTTOM PLATE
7	10003-028	2	CROSSBAR, LOWER
8	99007-001	4	FOOT, SUCTION, #8-32
9	10020-428	1	ASSEMBLY, FAN, 115 VAC, 81 CFM
10	-	4	SCREW, BUTTON HEAD, #10-24 X 1/2
11	-	4	HEX NUT, #10-24

PRELIMINARY

**PITNEY BOWES**  
*Sure-Feed Engineering*

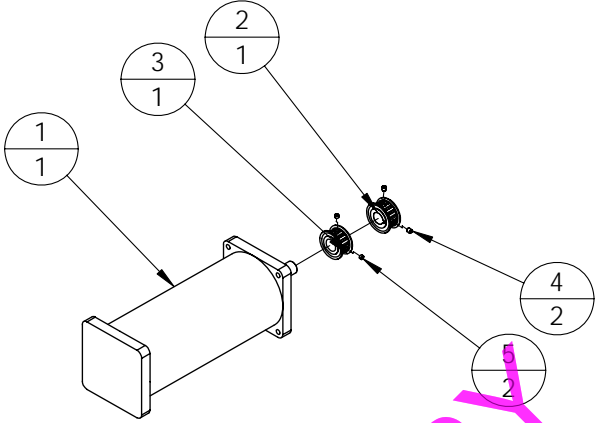

ASSY# 10020-426

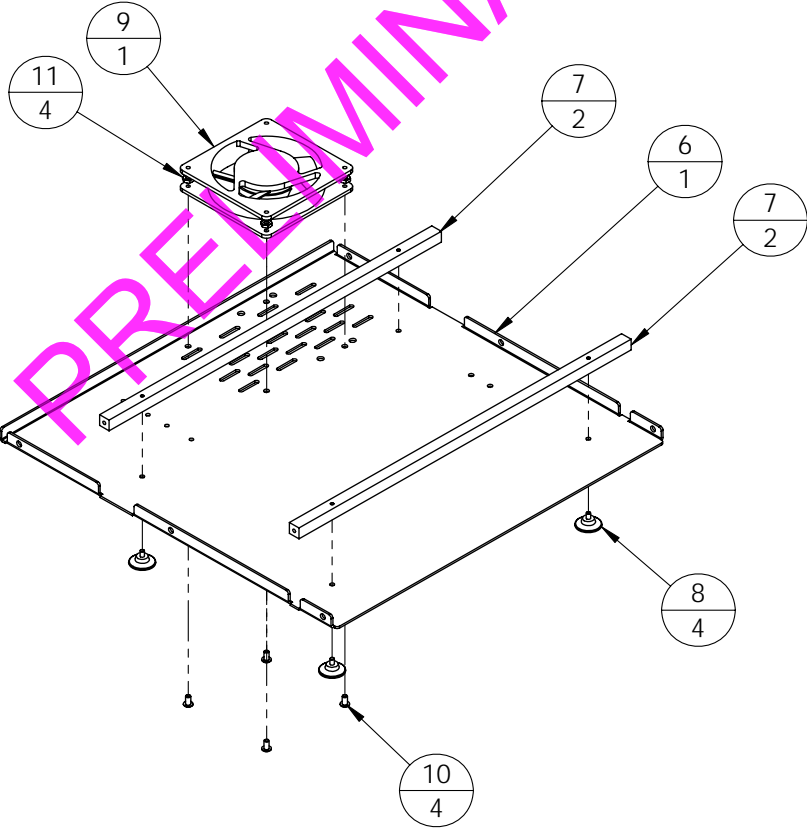

ASSY# 10020-412

**PITNEY BOWES**  
*Sure-Feed Engineering*

**20" FORCE FLEX FEEDER (Fig. 13)  
 TOP COVER ASSEMBLY (10020-494)**

ITEM	PART NO.	QTY.	DESCRIPTION
1	10001-051		TOP COVER
2	<b>10020-422</b>	<b>1</b>	<b>ASSEMBLY, VIBRATOR TOP</b>
<b>2A</b>	10007-120	1	PLATE, REAR WEDGE MTG.
<b>2B</b>	10007-124	1	BLOCK, SPRING MTG.
<b>2C</b>	10007-113	3	BLOCK, REAR WEDGE PLATE GUIDE
<b>2D</b>	10009-080	1	BRACKET, VIBRATION DRIVE
<b>2E</b>	10004-054	1	SHAFT, VIBRATING ROLLER MTG.
<b>2F</b>	99003-001	1	BEARING, SEALED, 3/8 X 7/8
<b>2G</b>	99003-016	2	WASHER, NYLON, 3/8 X 1/32
<b>2H</b>	99022-003	2	SNAP RING, 3/8
<b>2J</b>	99006-038	2	PIN, SPRING MTG, #10-32 X 5/8
<b>2K</b>	10007-111	1	NUT, PAPER SLIDE
<b>2L</b>	10007-004	1	WASHER, PAPER SLIDE
<b>2M</b>	99006-020	1	PIN ROLL, 5/32 X 5/8
<b>2N</b>	10020-429	1	KNOB, #10-24 X 5/8
<b>2P</b>	-	8	SCREW, SKT HEAD, #10-24 X 3/8
<b>N/S</b>	99005-022	2	SPRING, EXTENSION
<b>3</b>	<b>10020-421</b>	<b>1</b>	<b>ASSY, REAR WEDGES</b>
	<b>10005-182</b>	<b>1</b>	<b>REAR WEDGE 1-1/2"</b>
	<b>10005-183</b>	<b>1</b>	<b>REAR WEDGE 5"</b>
	<b>10005-184</b>	<b>1</b>	<b>REAR WEDGE 10"</b>
4	-	2	SCREW, FLAT HEAD, #8-32 X 3/8

**PITNEY BOWES**  
*Sure-Feed Engineering*

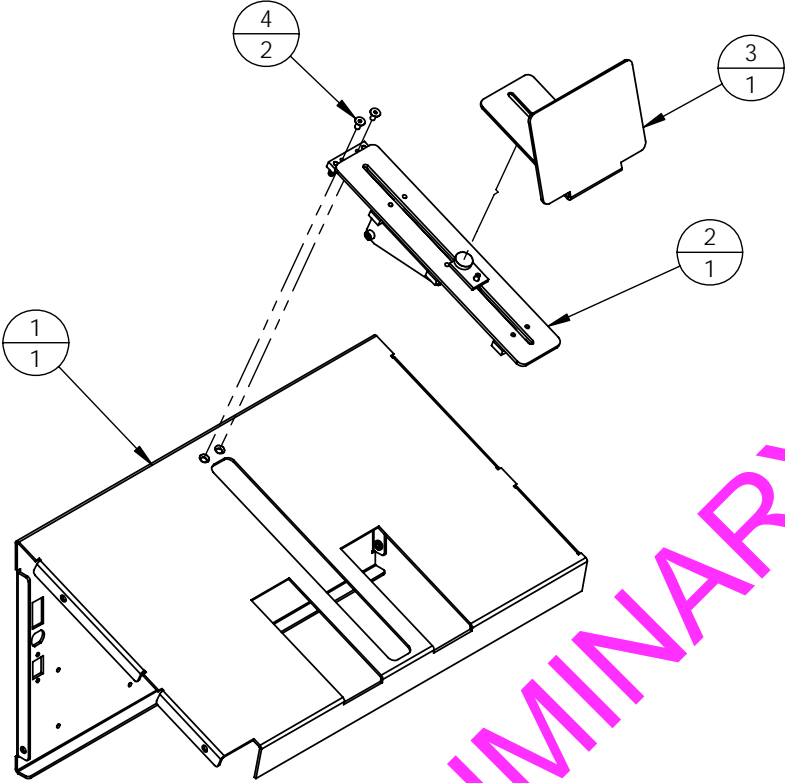
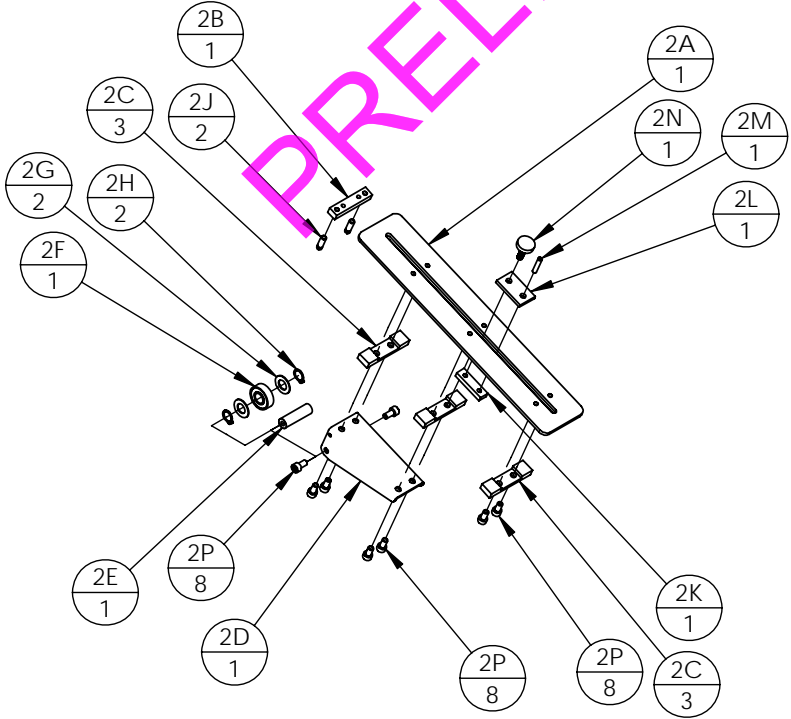

FIG 13



PRELIMINARY

**PITNEY BOWES**  
*Sure-Feed Engineering*

**20" FORCE FLEX FEEDER (Fig. 14)  
 CARRIAGE TENSIONER & IDLER ASSEMBLIES**

ITEM	PART NO.	QTY.	DESCRIPTION
	<b>10020-423</b>	<b>1</b>	<b>ASSEMBLY, CARRIAGE IDLER</b>
1	10004-231	1	SHAFT, FIXED STUB IDLER
2	10006-118	1	PULLEY, IDLER, 30XL075
3	99003-108	2	BEARING, 1/2 X 1-1/8 SHIELDED
4	99003-032	2	WASHER, NYLON, 1/2 X 1/32
5	99022-004	2	SNAP RING, 1/2
	<b>10020-424</b>	<b>1</b>	<b>ASSEMBLY, CARRIAGE TENSIONER</b>
6	16004-032	1	SHAFT, ECCENTRIC IDLER, 3/8
7	10006-117	1	PULLEY, IDLER, 20XL075
8	99003-001	2	BEARING, 3/8 X 7/8
9	99003-016	2	WASHER, NYLON, 3/8 X 1/32
10	99022-003	1	SNAP RING, 3/8

PRELIMINARY

**PITNEY BOWES**  
*Sure-Feed Engineering*

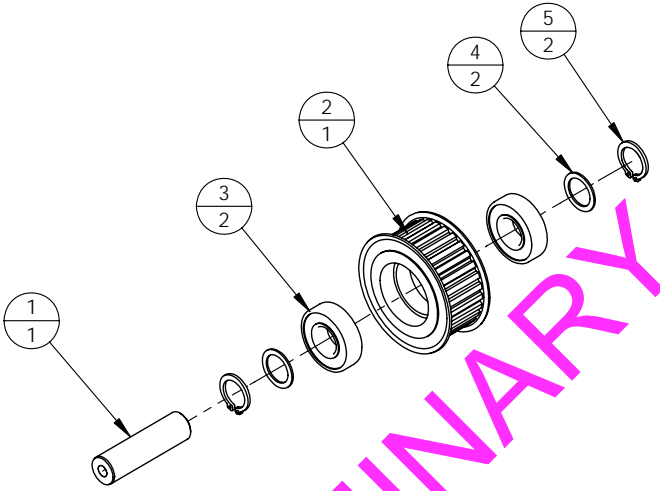

ASSY# 10020-423

PRELIMINARY

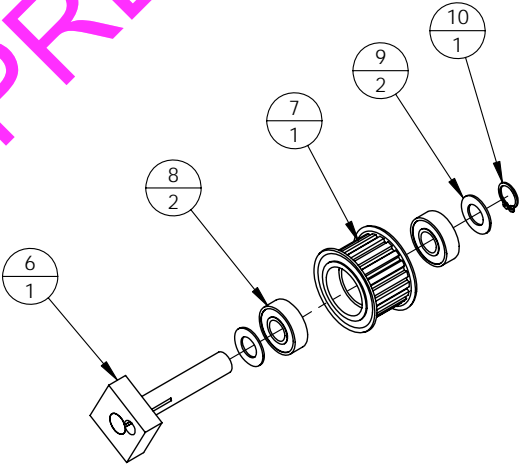

ASSY# 10020-424